



湖南多灵过滤系统科技有限公司
HUNAN DAWNING FILTER SYSTEM TECHNOLOGY CO.,LTD

FILTRATION SYSTEM FOR IRRIGATION

农业灌溉首部过滤系统

智能反冲洗系统 | 模块化快速维护 | 全场景过滤解决方案



COMPANY PROFILE

公司简介

湖南多灵过滤系统科技有限公司是高新技术企业，国内农业灌溉过滤领域的开拓者与头部品牌(CDFS)。公司专注智能化灌溉首部过滤系统研发，产品涵盖砂石、叠片、离心及水力驱动自清洗四大过滤器系列，提供全场景集成解决方案，累计服务全球超15000+余个项目，节水超1000万吨。

通过ISO9001及CE认证，公司建成智能生产基地并配备工业机器人产线，年产能50,000套，支持标准化与定制化生产。产品销往全球30余国，在加拿大、澳大利亚、南非等农业发达市场建立深度合作。

多灵以"智能节水·科技兴农"为核心理念，凭借稳定性能、快速响应与技术创新，为全球农业提供智能过滤系统，推动可持续农业发展。

Hunan Dawning Filtration Systems Technology Co., Ltd. is a national high-tech enterprise and a pioneer and leading brand(CDFS) in China's agricultural irrigation filtration industry. Specializing in the R&D of intelligent primary filtration systems for irrigation, we offer four core product series: sand, disc, centrifugal, and hydraulic self-cleaning filters, providing integrated solutions for all scenarios. Accumulatively serving over 15000+projects worldwide, saving over 10 million tons of water.

Certified with ISO9001 and CE standards, we operate a smart production base equipped with industrial robotic production lines, achieving an annual production capacity of 50,000 units. Our solutions support both standardized and customized production, with products exported to over 30 countries and deep collaborations established in agriculturally advanced markets such as Canada, Australia, and South Africa.

Guided by the philosophy of "Smart Water Conservation · Technology Empowering Agriculture", CDFS delivers intelligent filtration systems globally through reliable performance, rapid response, and technological innovation, driving sustainable agricultural development.



目录 CONTENTS

SCHEMATIC DIAGRAM OF IRRIGATION SYSTEM 灌溉系统示意图	01-02
DMF SAND FILTER DMF砂石过滤器	03-06
DLLF AUTOMATIC DISC FILTER DLLF叠片过滤器	07-08
DLHF300 SERIES HYDRAULIC SCREEN FILTER DLHF300系列立式水力驱动网式过滤器	09-10
DLHF400 SERIES HYDRAULIC SCREEN FILTER DLHF400系列卧式水力驱动网式过滤器	11-12
DLDELECTRIC BRUSH SELF-CLEANING FW SERIES DLD电动刷式网式自清洗FW系列	13-14
DLDELECTRIC BRUSH SELF-CLEANING FZ SERIES DLD电动刷式网式自清洗FZ系列	15-16
DLLW CENTRIFUGAL DOUBLE MESH FILTER / DLFT FERTILIZER TANK DLLW离心双网过滤器 / DLFT施肥罐	17-18
DLPF PUMP FRONT FILTER DLPF泵前过滤器	19
SITE CASE SHARING 现场案例分享	20

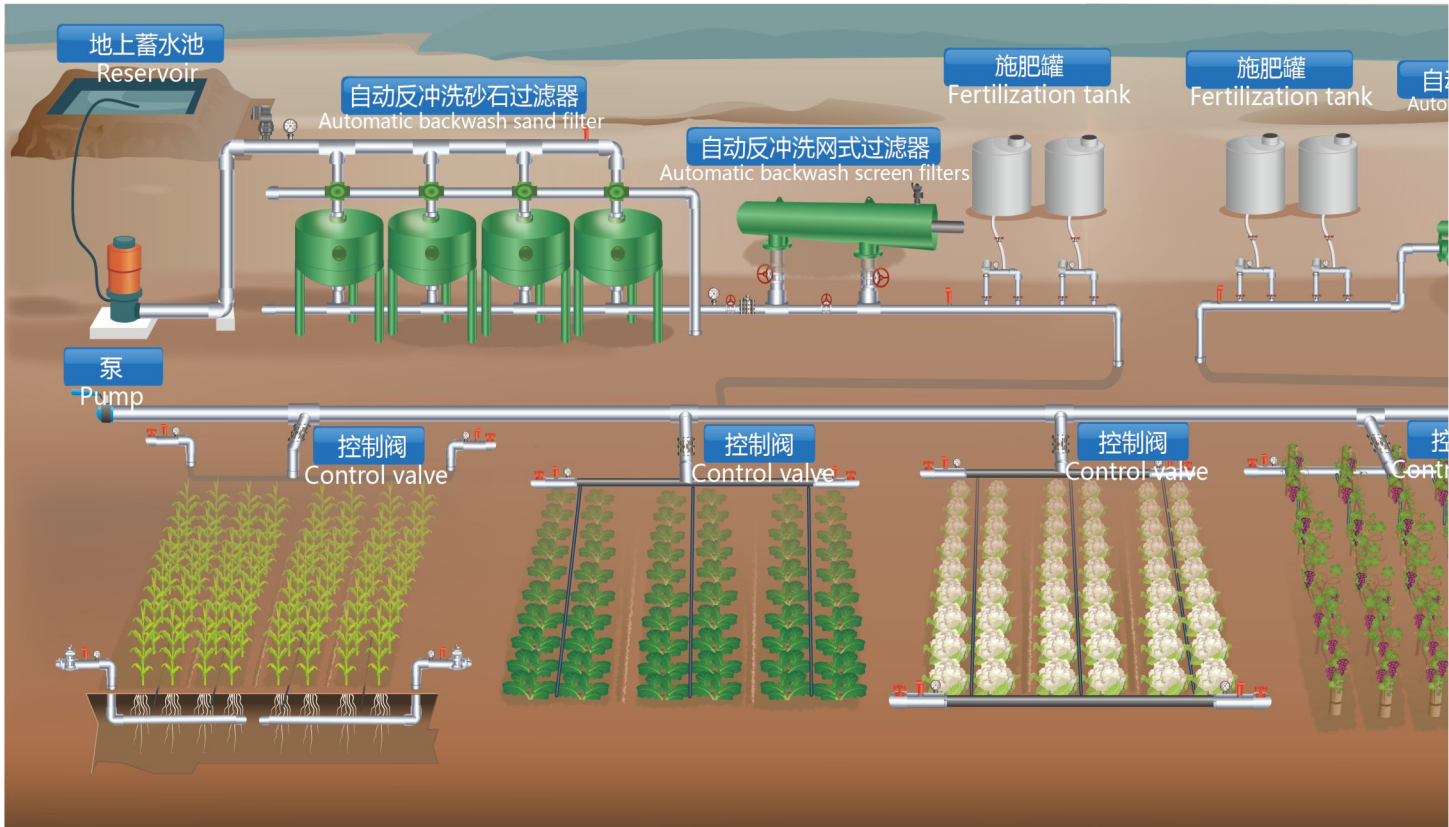

农业灌溉过滤系统解决方案

智能净水守护每一滴灌溉价值

在现代农业灌溉中，喷灌、滴灌等节水技术常因水质问题遭遇瓶颈。未经处理的井水、河水等水源含沙粒、藻类等杂质，易造成灌水器堵塞，导致设备寿命缩短30%以上，后期维护成本激增，直接影响作物供水稳定性与农业生产效益。

In modern agricultural irrigation, water-saving technologies such as sprinkler and drip irrigation often encounter bottlenecks due to water quality issues. Untreated water sources such as well water and river water contain impurities such as sand and algae, which can easily cause blockages in irrigation devices, shorten equipment lifespan by more than 30%, and increase maintenance costs in the later stages, directly affecting the stability of crop water supply and agricultural production efficiency.

多灵深耕过滤领域23年，提供从水源分析、方案设计到设备运维的一站式解决方案，已服务全球超15000+农业项目。选择专业过滤系统，就是选择持续稳定的灌溉保障！

Dawning has been deeply involved in the field of agricultural filtration for 23 years, providing one-stop solutions from water source analysis, scheme design to equipment operation and maintenance, we have served over 15000 agricultural projects worldwide. Choosing a professional filtration system means choosing a continuous and stable irrigation guarantee!

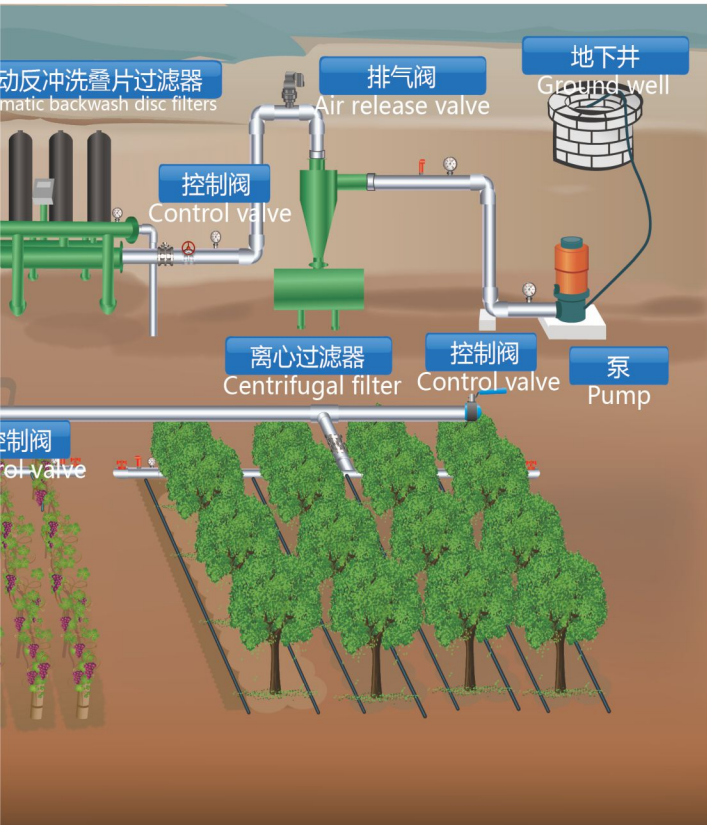

砂石过滤器

专业处理藻类、有机物等黏性杂质, 应对复杂水源环境
Professional handling of viscous impurities such as algae and organic matter to cope with complex water source environments.

叠片过滤器

精密拦截40-200微米杂质, 适配滴灌系统的高标准过滤需求
Precise interception of impurities ranging from 40-200 microns, suitable for high standard filtration requirements of drip irrigation systems.

网式过滤器

20-150目可选滤网, 经济实用的终端精细过滤保障
20-150 mesh optional filter, economical and practical terminal fine filtration guarantee.

离心过滤器

针对高含沙量水源, 通过旋流分离技术清除80%以上悬浮颗粒
For high sediment content water sources, more than 80% of suspended particles are removed through cyclone separation technology.



25%

售后维护成本降低25%
Reduce after-sales maintenance costs by 25%

40%

单机生产时效提升40%
Single machine production efficiency increased by 40%

65%

人工成本降低65%
Reduce labor costs by 65%

90%

堵塞故障率降低90%以上
Reduce blockage failure rate by over 90%

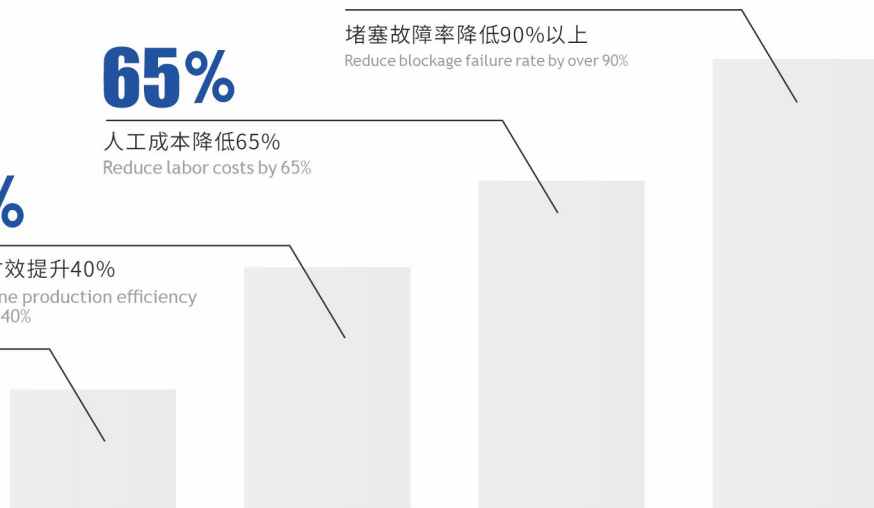

DMF SAND FILTER

DMF 砂石过滤器



一级过滤, 利用砂床的三维过滤, 有效处理水中有机杂质和无机杂质, 适用于水源为地表水或水中有机物含量超过10mg/L的水质。

Using three-dimensional filtration of sand, as primary filtration to deal with organic and inorganic impurities in water. Sand filters should be selected once the contents of organic impurities in the water is over 10mg/l.

FEATURES

产品特点

- 高滤速, 低压损
- 模块化设置, 占地面积小, 配管少, 投资省
- 根据灌溉工程用量及过滤要求, 可单独使用, 也可多个组合
- 自动反冲洗, 实现不间断供水

- High flow rate with low pressure loss.
- Modularized setting, compact, with less piping reducing the investment.
- One or multi-parallel filtration units are available according to the requirement of irrigation project.
- Automatic backwash, continuous water supply.

DESCRIPTION

型号说明

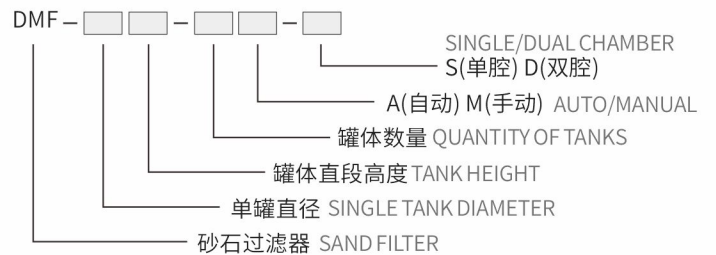

PARAMETER

控制参数

单罐处理水量 Capacity/tank	过滤精度范围 Precision	设计压力 Design pressure	最小工作压力 Min pressure	工作温度 Working temp	压力损失 Pressure loss
15-80m ³ /h	5-40Mic	0.8MPa/8Bar	0.2MPa/2Bar	≤65°C	≤0.02MPa/0.2Bar
控制方式 Control methods	清洗时间 Backwash time	输入电源 Input power supply		集水器材质 Collector material	整体撬装 便于运输与安装
压差、时间及手动 (DP/time/manual)	10-200s	AC220V/50Hz	DC9-24V	ABS	Skid mount package/easy to install

※ 压力、材质有特殊要求可定制, 详情请向公司咨询。
NOTE: Pressure, material has special requirements can be customized, please consult us for details.

TECHNICAL DATA TABLE

选型表

型号 Model	罐体数量 Quantities of tank	最小流量(m ³ /h) Min flow rate	最大流量(m ³ /h) Max flow rate	过滤面积(m ²) Filtration area	单罐反洗流量(m ³ /h) Backwash flow rate	最大压力(MPa) Max pressure	进出水口(DN) Water inlet/outlet	排污管 Drain outlet
DMF-2416-2A	2	27	50	0.56	22	0.8	3"	2"
DMF-3216-2A	2	60	80	1.0	40	0.8	4"	3"
DMF-3616-2A	2	75	100	1.28	50	0.8	4"	3"
DMF-4016-2A	2	80	120	1.88	60	0.8	6"	3"
DMF-4816-2A	2	100	160	2.26	80	0.8	6"	3"
DMF-4816-3A	3	150	240	3.39	80	0.8	8"	3"
DMF-4816-4A	4	200	320	4.52	80	0.8	8"	3"

※ 实际流量与水质及过滤精度有直接关系, 详情请向公司咨询。

NOTE: The actual flow is directly related to the water quality and precision, please consult us for details.

DIMENSION

尺寸表

型号Model	D(mm)	L1(mm)	H1(mm)	H2(mm)	L*W*H(mm)	Weight(kg)
DMF-2416-2A	600	700	235	1410	1300*640*1640	155
DMF-3216-2A	800	900	255	1640	1770*820*1970	240
DMF-3616-2A	900	900	255	1640	1976*910*1916	275
DMF-4016-2A	1000	1200	300	1830	2100*1010*1850	320
DMF-4816-2A-S	1200	1400	230	1930	2500*1220*1900	520
DMF-4816-2A-D	1200	1400	600	1780	2610*1545*2186	590
DMF-4816-3A-S	1200	1400	240	1840	3900*1200*1950	790
DMF-4816-3A-D	1200	1400	600	1810	4010*1610*2230	880
DMF-4816-4A-S	1200	1400	240	1810	5500*1200*2280	1000
DMF-4816-4A-D	1200	1400	600	1810	5410*1610*2230	1160

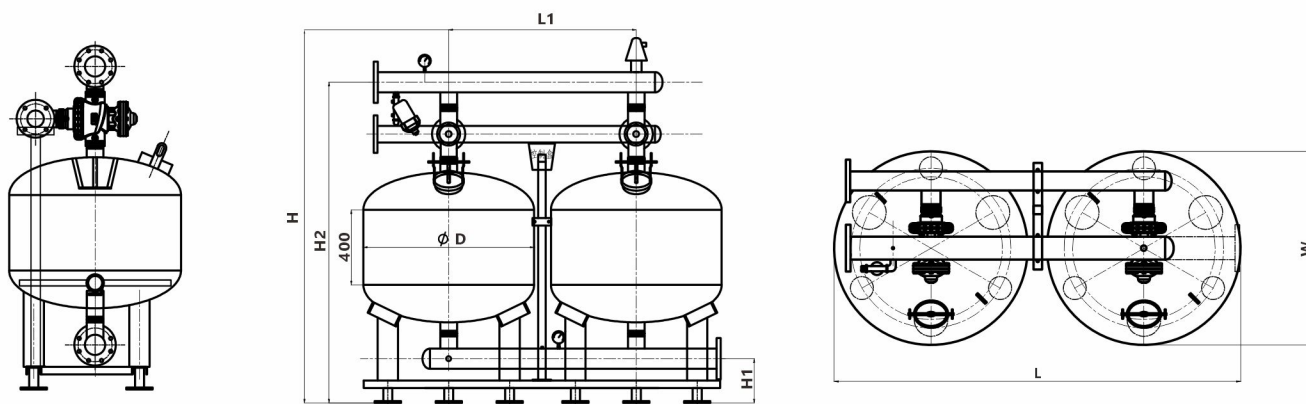

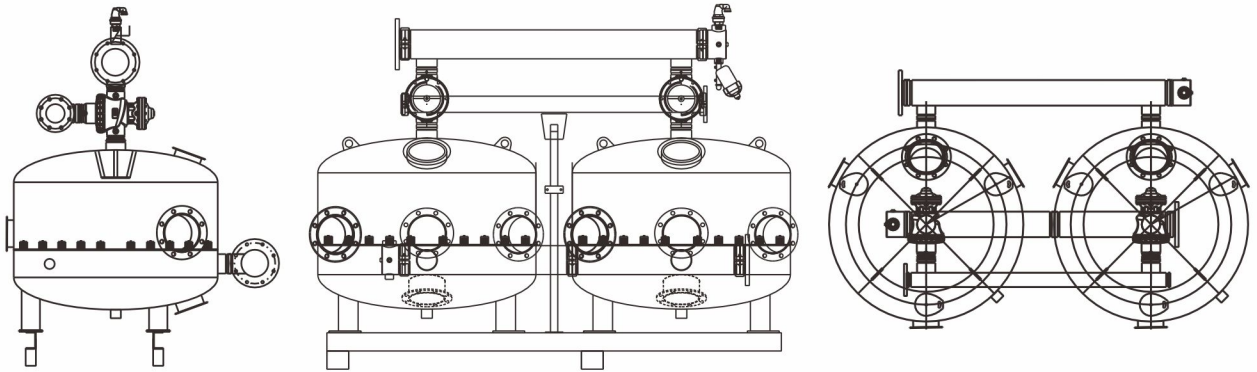

INSTALLATION FORM

安装形式

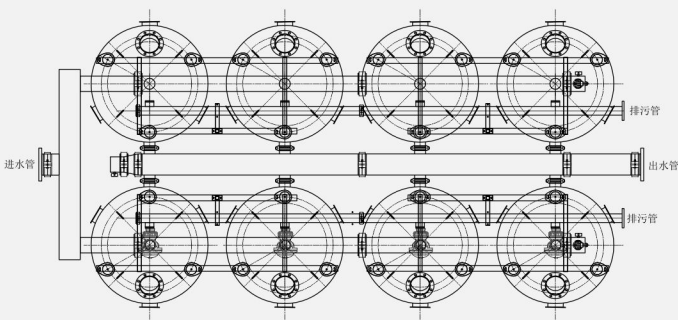
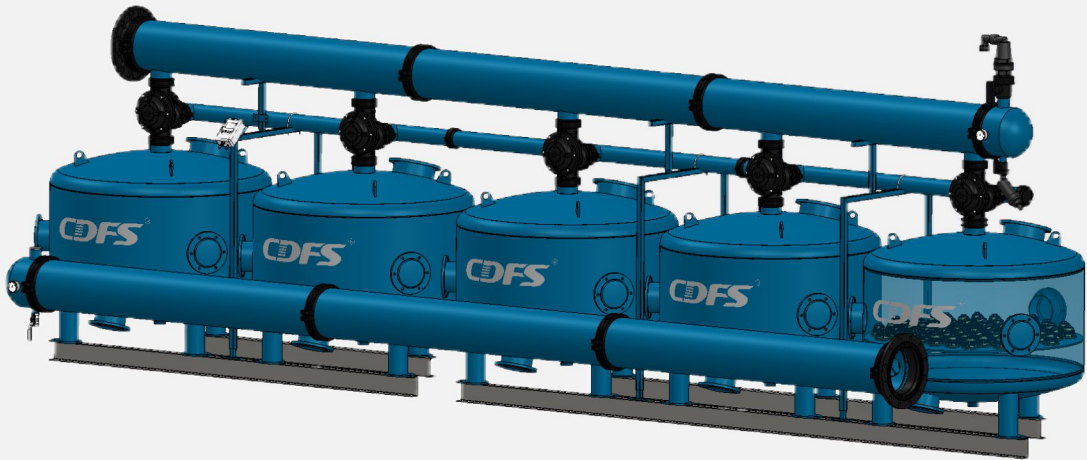

双排 (共用出水口)

DOUBLE ROW (SHARED OUTLET)

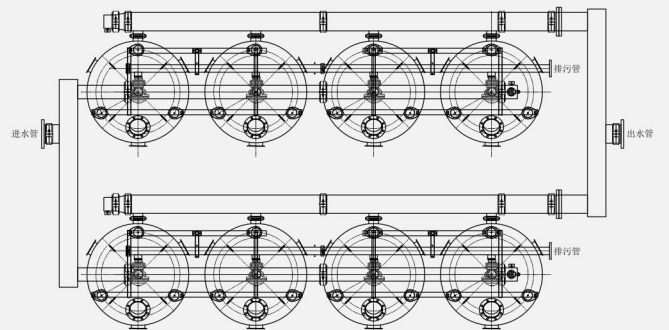

双排 (含连接管路)

DOUBLE ROW (WITH PIPES)

ABS材质, 新型橡胶板螺纹卡扣接口, 检修更方便
Abs Material, New Rubber Plate Threaded Buckle
Interface, Easier Maintenance.

水帽
Water Cap



鱼刺结构, 强度高, 寿命长
独特的结构能实现360度无死角反冲洗
相比传统集水器增加30%通流面积

Fishbone Structure: High Strength, Long Lifespan
360° Backwash: Unique design for complete cleaning
30% More Flow Area vs. Traditional Collectors.

滤棒
Underdrain

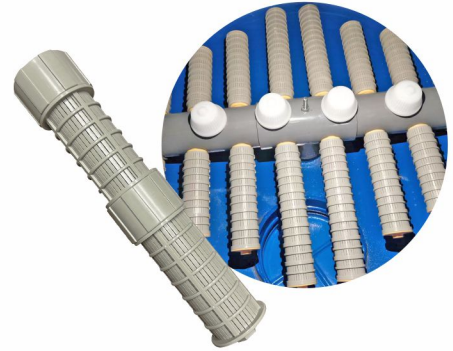

两位三通阀
Backwash Valve



材质金属和尼龙可选, 强度更高更耐用
Available In Metal And Nylon Materials For Higher Strength And Durability.

DLLF AUTOMATIC DISC FILTER

DLLF 叠片过滤器

作为灌溉系统中的二级过滤,有效去除灌溉水中的纤维状杂质,尤其对软性杂质和纤维状杂质有很高的捕捉能力。

As a secondary filter in irrigation systems, it effectively removes fibrous impurities from irrigation water, especially with high capture ability for soft and fibrous impurities.



FEATURES

产品特点

- 在线过滤不断流,全自动反冲洗
 - 高精度、占地面积小,灵活组装
 - 过滤杂质多样,包括无机杂质(沙子、沉积物等)、有机杂质(种子、漂浮物等)
- Automatic backwash and continuously water supply during flushing.
 - High filtration precision, compact, flexible assembly.
 - Filtering various impurities including inorganic impurities (sand, sediment, etc.), organic impurities (seeds, algae, floats, etc).

DESCRIPTION

型号说明



高耐压增强玻璃纤维材料,卡箍锁定方便开启
High-Pressure Fiberglass, Easy Open With Victaulic Clamp



聚丙烯材质,柱形体过滤体系,过滤效果更可靠
PP Material, Cylindrical Filter, Reliable Filtration

TECHNICAL DATA TABLE

选型表

型号 Model	接口 Inlet/outlet dia.	过滤流量(m ³ /h) Flow rate	进出水口管道(DN) Dia. of pipe	H (mm)	H1 (mm)	H2 (mm)	D (mm)	L (mm)
DLLF-2-2-A	3inch/89mm	≤30	80	964	215	185	710	615
DLLF-2-3-A	4inch/108mm	45	100	1000	225	195	750	890
DLLF-3-2-A	4inch/108mm	60	100	1165	235	245	835	615
DLLF-3-3-A	4inch/108mm	90	100	1255	300	266	928.5	890
DLLF-3-4-A	6inch/159mm	120	150	1295	300	266	928.5	1165
DLLF-3-5-A	8inch/219mm	150	200	1320	300	266	953.5	1440
DLLF-4-3-A	8inch/219mm	176	200	1640	210	1180	1200	950
DLLF-4-4-A	8inch/219mm	210	200	1700	210	1180	1200	1225
DLLF-4-5-A	8inch/219mm	294	200	1755	285	1320	1200	1500
DLLF-4-6-A	10inch/273mm	352	250	1655	285	1320	1200	1775
DLLF-4-7-A	10inch/273mm	420	250	1763	285	1400	1200	2050

※ 实际流量与水质及过滤精度有直接关系, 详情请向公司咨询。
NOTE: The actual flow is directly related to the water quality and precision, please consult us for details.

2" 3" units drawing

二、三寸机组尺寸图

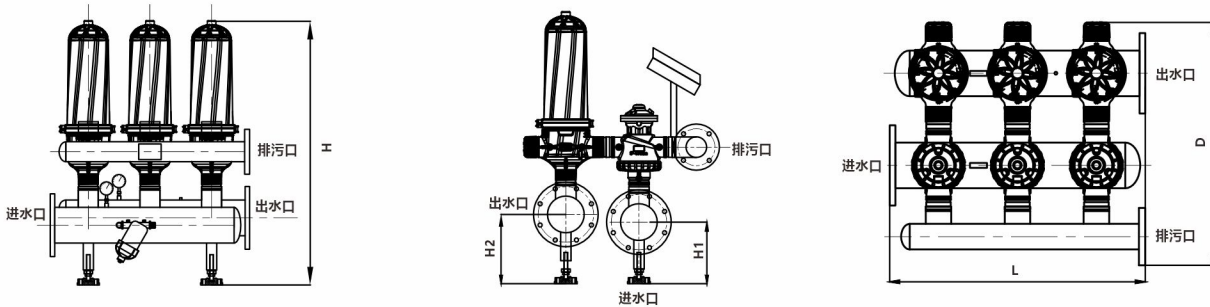

4" units drawing

四寸机组尺寸图

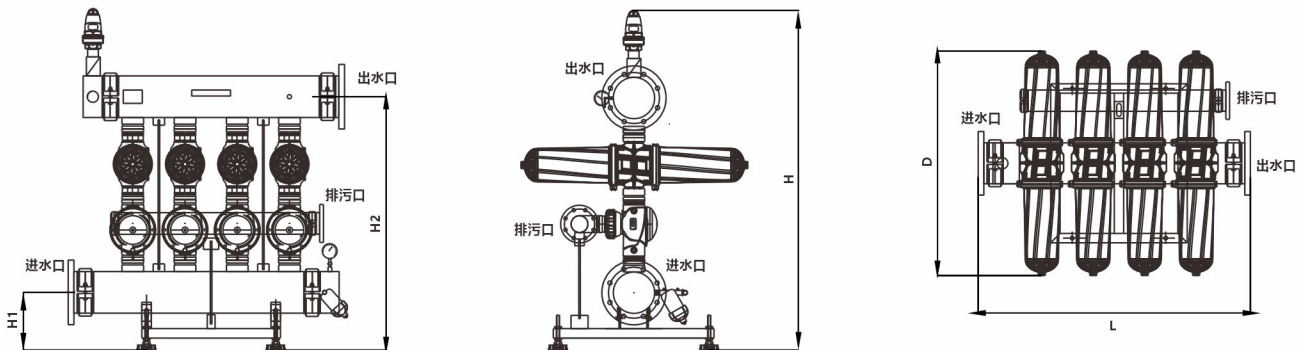

DLHF300 SERIES HYDRAULIC SCREEN FILTER

DLHF300系列立式水力驱动网式过滤器

单级过滤, 本体内是不锈钢滤网, 主要用于过滤灌溉水中的杂质、砂粒和水垢等污物, 也可用于过滤含有少量有机物的灌溉水, 适用流量 10m³/h-200m³/h 的灌溉水系统。

Using a stainless steel screen mesh to remove the silt, sand and scale dirt from the water. Irrigation water containing few organics could also be filtered. The available flow rate is from 10m³/h to 200m³/h.



FEATURES

产品特点

- 完全依靠系统管线内的水压, 无需外部动力
- 全自动智能化控制
- 具备全自动反冲洗功能
- Entirely controlled by the hydraulic pressure in the pipeline, external power is not needed.
- Fully-automatic control.
- Automatic back wash.

DESCRIPTION

型号说明

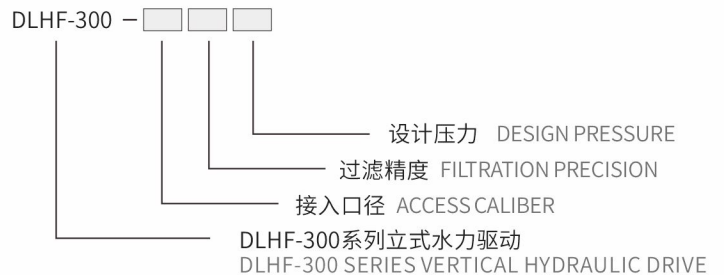

PARAMETER

控制参数

单台处理水量 Capacity/tank	过滤精度范围 Precision	设计压力 Design pressure	最小工作压力 Min pressure	滤网材质 Material of mesh
10-200m ³ /h	25-2000Mic	1.0MPa/10Bar	0.2MPa/2Bar	SS304/316
控制方式 Control methods	清洗时间 Backwash time	工作温度 Working temp	压力损失 Pressure loss	过滤器自清洗完全依靠系统管线内的水压, 无需外部动力
压差、时间及手动 (DP/time/manual)	10-200秒可调 (10-200sec optional)	≤65°C	≤0.01MPa/0.1Bar	No external power required for the back washing

※ 压力、材质有特殊要求可定制, 详情请向公司咨询。
NOTE: Pressure, material has special requirements can be customized, please consult us for details.

TECHNICAL DATA TABLE

选型表

型号 Model	进/出水口(mm) Water inlet/outlet	滤网面积(cm ²) Screen area	流量(m ³ /h) Flow rate	重量(Kg) Weight
DLHF-302	50	1720	20	42
DLHF-303	80	1720	50	47
DLHF-304	100	1720	80	60
DLHF-304MAX	100	3430	100	82
DLHF-306	150	4330	130	90
DLHF-308	200	5500	200	182

※ 实际流量与水质及过滤精度有直接关系, 详情请向公司咨询。

NOTE: The actual flow is directly related to the water quality and precision, please consult us for details.

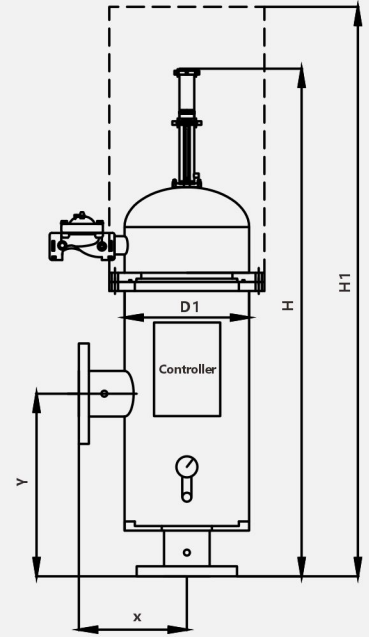

活塞 Piston



采用不锈钢材质更耐用, 寿命长
Made Of Ss Longer Lifespan

滤网 Screen

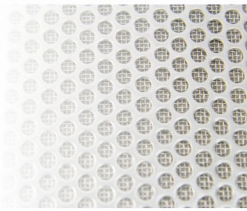

编织复合型, 开孔率高, 通流量大, 拦截效率高
Woven Type, Large Filtration Area

DIMENSION

尺寸表

型号 Model	D1 (mm)	X (mm)	Y (mm)	H (mm)	H1 (mm)
DLHF-302	273	237	250	805	955
DLHF-303	273	237	250	805	955
DLHF-304	273	237	250	805	955
DLHF-304MAX	273	237	400	1055	1355
DLHF-306	273	237	550	1185	1655
DLHF-308	325	283	560	1375	1955

DLHF400 SERIES HYDRAULIC SCREEN FILTER

DLHF400系列卧式水力驱动网式过滤器

双级过滤, 本体内是不锈钢滤网, 主要用于过滤灌溉水中的杂质、砂粒和水垢等污物, 也可用于过滤含有少量有机污物的灌溉水, 适用流量 $50\text{m}^3/\text{h}$ - $1500\text{m}^3/\text{h}$ 的灌溉水系统。

Using a stainless steel screen mesh to remove the silt, sand and scale dirt from the water. Irrigation water containing few organics could also be filtered. The available flow rate is from $50\text{m}^3/\text{h}$ to $1500\text{m}^3/\text{h}$.



FEATURES

产品特点

- 完全依靠系统管线内的水压, 无需外部动力
- 全自动智能化控制
- 双级过滤, 具备全自动反冲洗功能

- Entirely controlled by the hydraulic pressure in the pipeline, external power is not needed.
- Fully-automatic control.
- Automatic back wash.

DESCRIPTION

型号说明

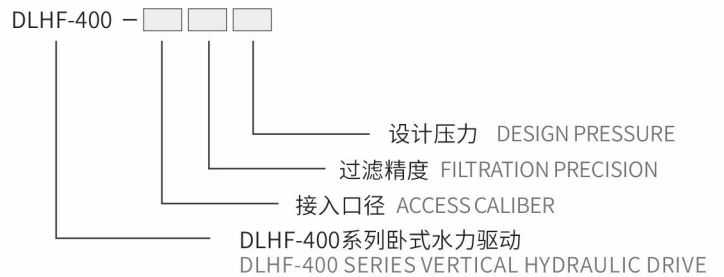

PARAMETER

控制参数

单台处理水量 Capacity/tank	过滤精度范围 Precision	设计压力 Design pressure	最小工作压力 Min pressure	滤网材质 Material of mesh
50-1500 m^3/h	20-2000Mic	1.0MPa/10Bar	0.2MPa/2Bar	SS304/316
控制方式 Control methods	清洗时间 Backwash time	工作温度 Working temp	压力损失 Pressure loss	过滤器自清洗完全依靠系统管线内的水压, 无需外部动力
压差、时间及手动 (DP/time/manual)	10-200秒可调 (10-200sec optional)	$\leq 65^\circ\text{C}$	$\leq 0.01\text{MPa}/0.1\text{Bar}$	No external power required for the back washing

※ 压力、材质有特殊要求可定制, 详情请向公司咨询。
NOTE: Pressure, material has special requirements can be customized, please consult us for details.

TECHNICAL DATA TABLE

选型表

型号 Model	进出水口(DN) Water inlet/outlet	滤网面积 (cm ²) Screen area	流量(m ³ /h) Flow rate	重量(Kg) Weight
DLHF-403	80	3220	50	140
DLHF-404	100	5780	100	170
DLHF-406	150	5780	150	183
DLHF-406MAX	150	8410	160	205
DLHF-408	200	5780	250	195
DLHF-408MAX	200	8410	300	235
DLHF-410	250	8410	350	250
DLHF-410MAX	250	10290	400	270
DLHF-412	300	11710	600	435
DLHF-414	350	12990	1000	455
DLHF-416	400	12990	1200	480
DLHF-416MAX	400	17020	1500	680

※ 实际流量与水质及过滤精度有直接关系, 详情请向公司咨询。

NOTE: The actual flow is directly related to the water quality and precision, please consult us for details.

活塞 Piston



采用不锈钢材质更耐用, 寿命长
Made Of Ss Longer Lifespan

滤网 Screen

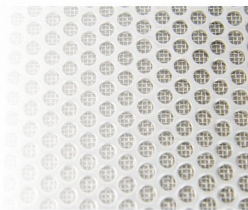

编织复合型, 开孔率高, 通流量大, 拦截效率高
Woven Type, Large Filtration Area

DIMENSION

尺寸表

型号 Model	D1(mm)	L1(mm)	L2(mm)	L3(mm)	H(mm)
DLHF-403	273	450	1570	2320	560
DLHF-404	273	900	1930	3050	580
DLHF-406	325	900	1930	3050	635
DLHF-406MAX	325	900	2120	3410	635
DLHF-408	325	900	2120	3410	635
DLHF-408MAX	325	900	2510	4210	640
DLHF-410	325	900	2510	4210	690
DLHF-410MAX	426	1100	2760	4690	760
DLHF-412	426	1100	3160	5490	760
DLHF-414	480	1270	3160	5490	820
DLHF-416	480	1270	3160	5490	820
DLHF-416MAX	630	1270	3160	5490	1020

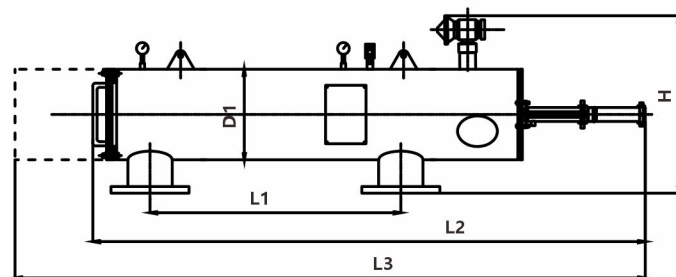

DLD ELECTRIC BRUSH SELF-CLEANING FW SERIES

DLD电动刷式网式自清洗FW系列

DLD电动刷式网式自清洗FW系列采用机械刷洗+反冲洗双模清洁,可自动清除水体中藻类、悬浮物等杂质,尤其适用于水库、河流等高浊度水源灌溉场景。其全自动运行特性降低90%人工清洗频次,节水15%以上。

The DLD electric brush mesh self-cleaning FW series adopts a dual mode cleaning of mechanical brushing and backwashing, which can automatically remove impurities such as algae and suspended solids in water bodies, especially suitable for high turbidity water source irrigation scenarios such as reservoirs and rivers. Its fully automatic operation feature reduces manual cleaning frequency by 90% and saves more than 15% water.



FEATURES

产品特点

- 流量大、过滤精度高
- 低压损、反洗水量少
- 自动化程度高

- Large traffic and high filtering accuracy.
- Low pressure loss and low backwash water volume.
- High degree of automation.

DESCRIPTION

型号说明

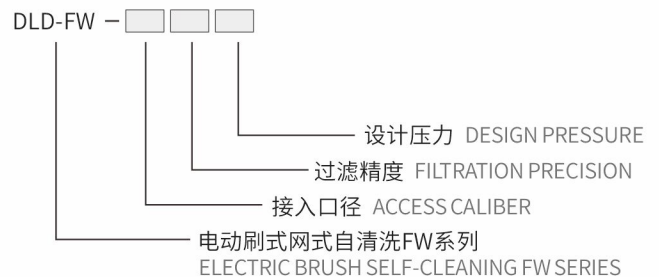

PARAMETER

控制参数

单台处理水量 Capacity/tank	过滤精度范围 Precision	设计压力 Design pressure	最小工作压力 Min pressure	滤网材质 Material of mesh
50-4000m ³ /h	20-4000Mic	1.6MPa/16Bar	0.1MPa/1Bar	SS304/316
控制方式 Control methods	清洗时间 Backwash time	工作温度 Working temp	压力损失 Pressure loss	过滤器自清洗完全依靠系统管线内的水压,无需外部动力
压差、时间及手动 (DP/time/manual)	10-200s	≤65°C	≤0.01MPa/0.1Bar	No external power required for the back washing

※ 压力、材质有特殊要求可定制,详情请向公司咨询。

NOTE: Pressure, material has special requirements can be customized, please consult us for details.

TECHNICAL DATA TABLE

选型表

型号 Model	进出水口(DN) Water inlet/outlet	排污口 (mm) Discharge outlet	电机功率(KW) Motor power	流量(m ³ /h) Flow rate	重量(Kg) Weight
DLD-FW-80	80	40	0.18	50	180
DLD-FW-100	100	40	0.18	80	198
DLD-FW-150	150	50	0.18	150	328
DLD-FW-200	200	50	0.25	320	375
DLD-FW-250	250	50	0.25	450	470
DLD-FW-300	300	50	0.37	600	519
DLD-FW-350	350	50	0.37	850	660
DLD-FW-400	400	50	0.37	1200	708

※ 实际流量与水质及过滤精度有直接关系, 详情请向公司咨询。

NOTE: The actual flow is directly related to the water quality and precision, please consult us for details.

DIMENSION

尺寸表

型号 Model	L(mm)	L1(mm)	L2(mm)	H(mm)
DLD-FW-80	450	1338	2038	493
DLD-FW-100	450	1338	2038	493
DLD-FW-150	900	1705	2705	545
DLD-FW-200	900	1765	2765	617
DLD-FW-250	900	1845	2895	720
DLD-FW-300	1100	2400	3792	800
DLD-FW-350	1100	2442	3792	800
DLD-FW-400	1100	2792	4142	900

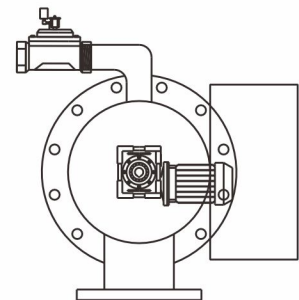
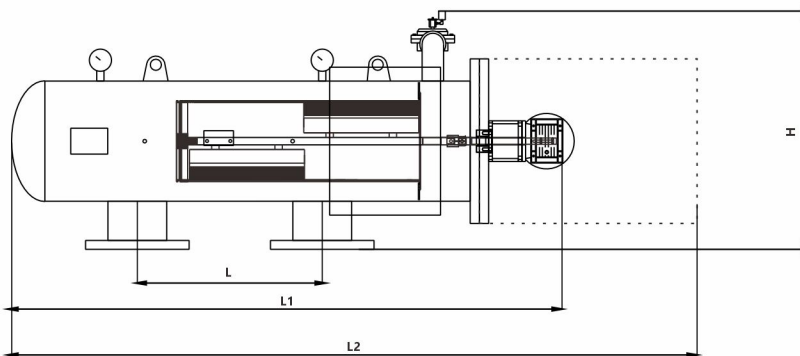

DLD ELECTRIC BRUSH SELF-CLEANING FZ SERIES

DLD电动刷式自清洗FZ系列



DLD电动刷式网式自清洗FZ系列采用机械刷洗+反冲洗双模清洁,可自动清除水体中藻类、悬浮物等杂质,尤其适用于水库、河流等高浊度水源灌溉场景。其全自动运行特性降低90%人工清洗频次,节水15%以上。

The DLD electric brush mesh self-cleaning FW series adopts a dual mode cleaning of mechanical brushing and backwashing, which can automatically remove impurities such as algae and suspended solids in water bodies, especially suitable for high turbidity water source irrigation scenarios such as reservoirs and rivers. Its fully automatic operation feature reduces manual cleaning frequency by 90% and saves more than 15% water.

FEATURES

产品特点

- 流量大、过滤精度高
- 低压损、反洗水量少
- 自动化程度高

- Large traffic and high filtering accuracy.
- Low pressure loss and low backwash water volume.
- High degree of automation.

DESCRIPTION

型号说明

DLD-FZ - [] [] []



PARAMETER

控制参数

单台处理水量 Capacity/tank	过滤精度范围 Precision	设计压力 Design pressure	最小工作压力 Min pressure	滤网材质 Material of mesh
10-2000m ³ /h	20-2400Mic	1.6MPa/16Bar	0.1MPa/1Bar	SS304/316
控制方式 Control methods	清洗时间 Backwash time	工作温度 Working temp	压力损失 Pressure loss	过滤器自清洗完全依靠系统管线内的水压,无需外部动力
压差、时间及手动 (DP/time/manual)	10-200s	≤65°C	≤0.01MPa/0.1Bar	No external power required for the back washing

※ 压力、材质有特殊要求可定制,详情请向公司咨询。

NOTE: Pressure, material has special requirements can be customized, please consult us for details.

TECHNICAL DATA TABLE

选型表

型号 Model	进出水口(DN) Water inlet/outlet	排污口 (mm) Discharge outlet	电机功率(KW) Motor power	流量(m ³ /h) Flow rate	重量(Kg) Weight
DLD-FZ-50	50	25	0.18	19	50
DLD-FZ-65	65	25	0.18	30	70
DLD-FZ-80	80	40	0.18	50	87
DLD-FZ-100	100	40	0.18	80	106
DLD-FZ-150	150	50	0.18	150	197
DLD-FZ-200	200	50	0.25	320	248
DLD-FZ-250	250	50	0.25	490	360
DLD-FZ-300	300	50	0.37	710	486
DLD-FZ-350	350	50	0.37	970	653
DLD-FZ-400	400	50	0.37	1260	765
DLD-FZ-450	450	50	0.37	1600	814
DLD-FZ-500	500	65	0.55	1970	920

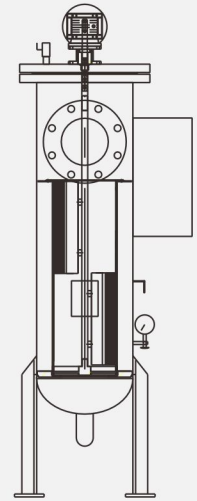

※ 实际流量与水质及过滤精度有直接关系, 详情请向公司咨询。
NOTE: The actual flow is directly related to the water quality and precision, please consult us for details.

DIMENSION

尺寸表

型号 Model	H(mm)	H1(mm)	H2(mm)	H3(mm)	H4(mm)	W(mm)
DLD-FZ-50	1100	770	200	425	1270	453
DLD-FZ-65	1200	820	180	500	1270	453
DLD-FZ-80	1200	820	180	500	1270	473
DLD-FZ-100	1530	1160	180	600	1780	473
DLD-FZ-150	1700	1200	200	700	1870	561
DLD-FZ-200	2040	1380	200	720	2360	617
DLD-FZ-250	2120	1465	200	720	2360	670
DLD-FZ-300	2610	1820	200	950	3150	830
DLD-FZ-350	2695	1820	200	950	3150	830
DLD-FZ-400	2700	1820	200	950	3310	930
DLD-FZ-450	2700	1820	200	950	3360	1020
DLD-FZ-500	2700	1820	200	950	3500	1020

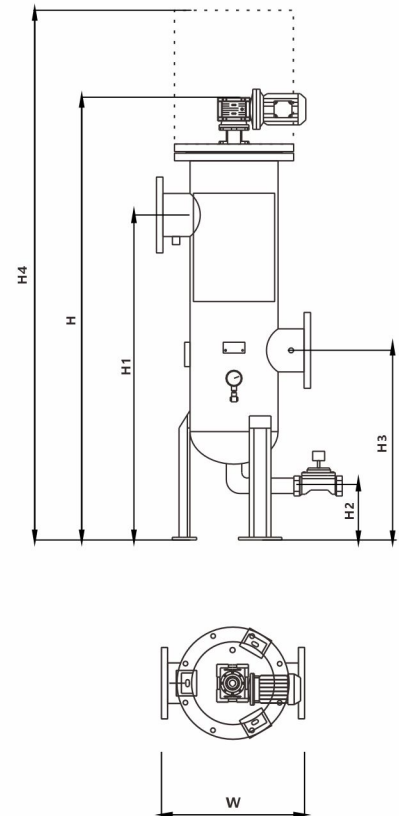

DLLW CENTRIFUGAL DOUBLE MESH FILTER

DLLW 手动离心网式过滤器

作为地下水、深井水及含砂量较大地表水的粗过滤，去除大颗粒状杂质，除砂率高达99%。

Used as the primary filtration of groundwater and deep well water to remove large particles. Sand removal rate is up to 99%.



FEATURES

产品特点

- 结构简单, 成本低廉
- 易于安装和操作, 无需维护
- 体积小, 处理水量大, 节省安装空间

- Simple structure, low cost.
- Easy to install and operate. Maintenance-free.
- Small and large volume processing capabilities, saving installation space.

DESCRIPTION

型号说明

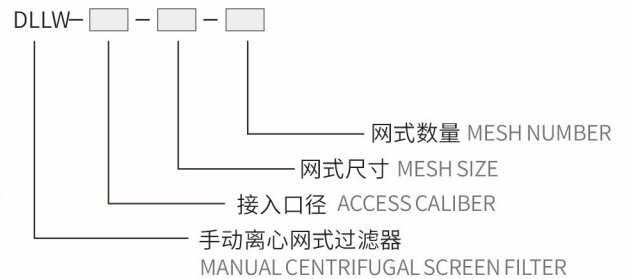

TECHNICAL DATA TABLE

选型表

型号 Model	接口 Inlet/outlet dia.	流量(m ³ /h) Flow rate	储砂罐容量(L) Sand storage tank volume	平均除砂率(%) Average sand removal rate
DLXL-50	2inch	20	20	>99
DLXL-80	3inch	50	36	>99
DLXL-100	4inch	80	60	>99
DLXL-150	6inch	160	100	>99

DIMENSION

尺寸表

型号 Model	D(mm)	L1(mm)	L2(mm)	L3(mm)
DLXL-50	219	780	985	485
DLXL-80	273	950	1230	645
DLXL-100	325	1025	1295	750
DLXL-150	377	1220	1570	940

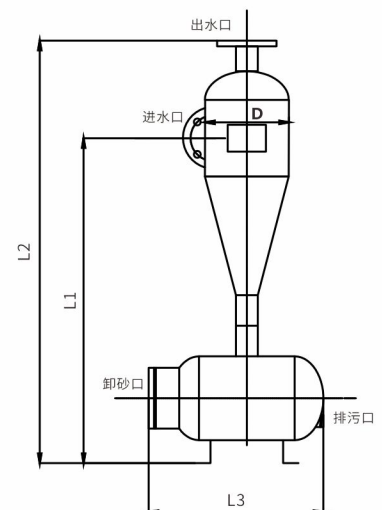

DIMENSION

尺寸表

型号 Model	H (mm)	H1 (mm)	H2 (mm)	L (mm)	W (mm)
DLLW-80-3-2	1600	950	200	1100	800
DLLW-100-4-2	1600	980	200	1200	800
DLLW-150-4-3	2100	1250	230	1500	950
DLLW-200-4-4	2250	1330	230	1650	1350

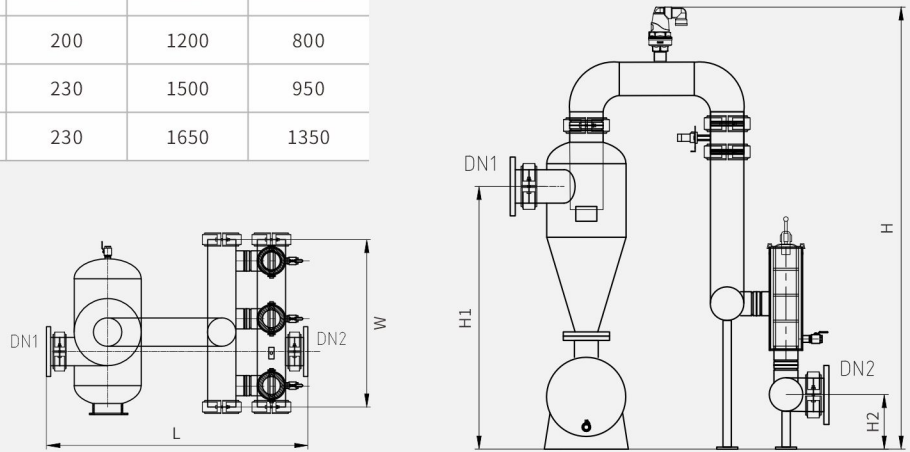

DLFT FERTILIZER TANK

DLFT 施肥罐

DIMENSION

尺寸表

型号 Model	容量(L) Capacity	D (mm)	H (mm)	H1 (mm)
DLFT-50	50	377	785	400
DLFT-100	100	426	1050	600
DLFT-200	200	530	1350	900
DLFT-300	300	630	1450	1000
DLFT-500	500	800	1500	900

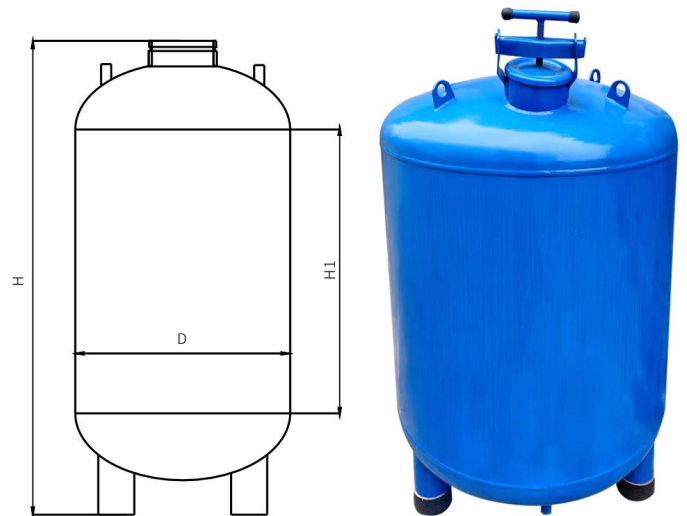

DLPF PRE PUMP FILTER

DLPF 泵前过滤器

设备采用泵前端过滤技术,对水源中的各种杂质和颗粒物进行过滤,降低浊度,净化水质,有效解决泵后管道水阻问题,保证滴灌系统恒压稳定,提高农业灌溉生产效率。设备结构轻便,易于安装和操作,对于环境要求不高,节约投资成本。

The equipment adopts pump front-end filtration technology to filter various impurities and particles in the water source, reduce turbidity, purify water quality, effectively solve the problem of water resistance in the pipeline after the pump, ensure constant pressure and stability of the drip irrigation system, and improve agricultural irrigation production efficiency. The device has a lightweight structure, is easy to install and operate, has low environmental requirements, and saves investment costs.

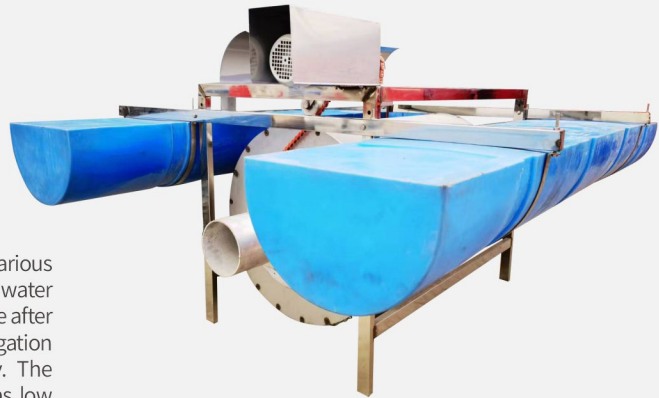

型号 Model	流量(m ³ /h) Flow rate	公称直径 Nominal diameter	L*W*H(mm)
DLPF-200	200	DN150	2400*1700*1300
DLPF-300	300-400	DN200	2600*1800*1350
DLPF-400	500	DN250	2600*1900*1400

技术参数 Technical Parameter

过滤系统 Filtration system	漂浮式过滤器(过滤网桶为304不锈钢编织网,网桶直径不小于800mm) Floating filter (filter drum made of 304 stainless steel woven mesh, with a diameter of not less than 800mm)
控制系统 Control system	/
过滤设备的工作介质 Working medium of filtering equipment	渠水、河水(地表水) Canal water, river water (surface water)
过滤精度(目) Filtering accuracy (mesh)	80-120
单台过滤器系统过滤流量(m ³ /h) Single filters system filters flow rate	200-500
控制方式 Control mode	自动、手动 Automatic、Manual
压力损失(MPa) Pressure loss	<0.05(系统工作压力0.25~0.4 Mpa条件下,正常工作5小时后) <0.05 (under the condition of system working pressure of 0.25-0.4 Mpa, after 5 hours of normal operation)
悬浮物含量(g/L) Suspend solid	无机固型≤100,有机≤5 Inorganic solid ≤ 100, organic ≤ 5
控制系统供电 Control system power supply	380V
机架 Rack	不锈钢材质 Stainless steel material
过滤元件(筛网) Filter element (sieve)	304不锈钢编织网 304 stainless steel woven mesh
滤网尺寸 Filter size	Φ800*1200筋丝1.0mm Φ800*1200 reinforcement wire 1.0mm
进水管 Water inlet	透明钢丝软管 Transparent steel wire hose



**SITE CASE
SHARING**
现场案例分享



Tel:0731-84391122 Web:www.cdfs.net/www.cncdfs.com

E-Mail:info@hndawning.com

办公地址:湖南省长沙市雨花区半山国际中心1406室

生产基地:湖南省岳阳市平江县兴园路多灵环保

Office Address: Room 1406, Banshan International Center, Yuhua District,
Changsha City, Hunan Province

Production Base: Dawning Environmental Protection, Xingyuan Road, Pingjiang
County, Yueyang City, Hunan Province



微信视频号



官方抖音号